

**Mi·Light<sup>®</sup>**  
**User Instruction**

**Smart Panel Remote Controller**  
Model No.: T1 / T2 / T3 / T4 & B1 / B2 / B3 / B4

## 1. Product Features

Smart Panel Remote Controller is a newly developed remote controller. This Panel remote controller is designed by a delicate and fashionable tempered glass panel; And we adopt a high precision Capacitive touch screen IC. Touch Screen is very stable; 2.4GHz high RF wireless control with long distance controlling, low power consumption and high speed transmitting rate.

This product has T series and B series, and the difference is the method of power supplying. Both series have 4 kinds: T1/B1 4-zone dimmable panel remote controller; T2/B2 CCT 4-zone panel remote controller; T3/B3 4-zone RGB/RGBW panel remote controller; T4/B4 4-zone RGB+CCT panel remote controller. This product widely work on our smart LED Lighting, LED Controller and Smart panel controller, etc.

Panel Remote Controller Name	Compatible Remote Model	Compatible products
4-Zone Brightness Dimming Panel Remote Controller	FUT091	Brightness dimming series
4-Zone CCT Adjust Panel Remote Controller	FUT091	CCT adjust series
4-Zone RGB/RGBW Panel Remote Controller	FUT095/FUT096	RGB / RGBW series
4-Zone RGB+CCT Panel Remote Controller	FUT092	RGB / RGBW RGB+CCT series

## 2. Technical Parameters

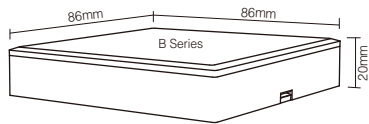

### **B Series: Powered by 3V(2\*AAA Battery)**

Working Temperature: -20-60°C	Transmitting Power: 6dBm
Input Voltage: 3V(2*AAA Battery)	Control Distance: 30m
Radio Frequency: 2400-2483.5MHz	Standby Power: 20uA
Modulation Method: GFSK	Size: L86mm*W86mm

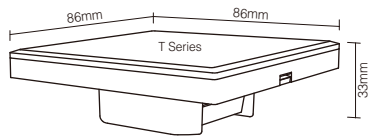

### **T Series: Powered by AC90-110V or AC180-240V**

Working Temperature: -20-60°C	Transmitting Power: 6dBm
Input Voltage: AC90-110V or AC180-240V	Control Distance: 30m
Radio Frequency: 2400-2483.5MHz	Size: L86mm*W86mm
Modulation Method: GFSK	

### 3. Installation/ Dismantlement

#### T series Installation/ Dismantlement

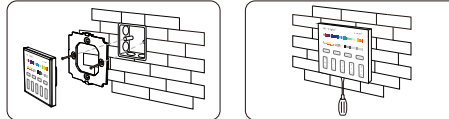

#### B series Installation/ Dismantlement

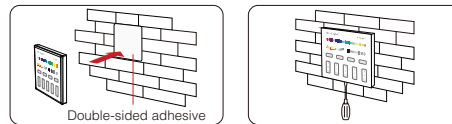

Double-sided adhesive

### 4. Attention

1. Please check the cable, and make the circuit is correct before power on.
2. When installation, pls handle with care to avoid the broken of the glass panel.





Made in China

## 5. Function of keys

**Remark:** When touching the button, LED indicating lamp will flash once with different sound(Touch slider with no sound).

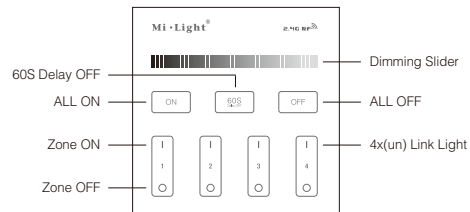
### B1 & T1



 Touch Dimming Slider to change the brightness from 1~100%.

 Touch Master ON, Turn on all linked lights.  
Long press 5 seconds to turn ON the indicating sound.

 When the light is ON, press "60S Delay OFF", the light will be OFF Automatically after 60 seconds.

 Touch Master OFF, Turn off all linked lights.  
Long press 5 seconds to turn OFF the indicating sound.

 Touch Zone ON, Turn on zone-linked lights.

 Touch Zone OFF, Turn off zone-linked lights.

### Link / Unlink

**Link:** First power off, then power on, within 3 seconds touch any of the Zone '1' button 3 times shortly, the link is done when you see the light blinks 3 times, otherwise try again later.

**Unlink:** First power off, then power on, within 3 seconds touch the linked Zone '1' button or the Master '1' button 5 times shortly, the unlink is done when you see the light blinks 9 times, otherwise try again later.

## B2 & T2

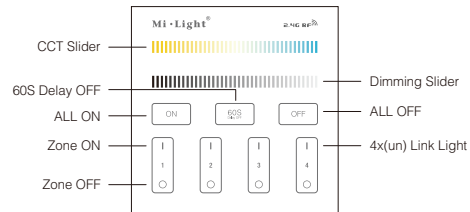

Touch the slider to change color temperature.

Touch Dimming Slider to change the brightness from 1~100%.

Touch Master ON, Turn on all linked lights.  
Long press 5 seconds to turn ON the indicating sound.

When the light is ON, press "60S Delay OFF", the light will be OFF Automatically after 60 seconds.

Touch Master OFF, Turn off all linked lights.  
Long press 5 seconds to turn OFF the indicating sound.

Touch Zone ON, Turn on zone-linked lights.

Touch Zone OFF, Turn off zone-linked lights.

### Link / Unlink

**Link:** First power off, then power on, within 3 seconds touch any of the Zone '1' button 3 times shortly, the link is done when you see the light blinks 3 times, otherwise try again later.

**Unlink:** First power off, then power on, within 3 seconds touch the linked Zone '1' button or the Master '1' button 5 times shortly, the unlink is done when you see the light blinks 9 times, otherwise try again later.

### B3 & T3

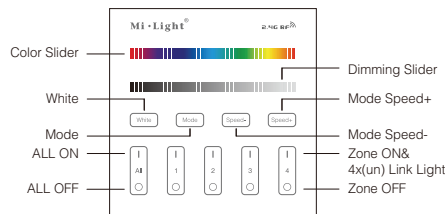

Touch Color Slider, Choose the color you want.

Touch Dimming Slider to change the brightness from 1~100%.

Touch White button to white light mode.

Switching Modes.

Slow the speed on present dynamic mode.

Accelerate the speed on present dynamic mode.

**ALL ON:** Touch turn on all linked lights.  
Long press 5 seconds to turn ON the indicating sound.

**Zone(1-4) ON:** Touch Zone ON, Turn on zone-linked lights.

**ALL OFF:** Touch turn off all linked lights.  
Long press 5 seconds to turn OFF the indicating sound.

**Zone(1-4) OFF:** Touch Zone OFF, Turn off zone-linked lights.

#### Link / Unlink

**Link:** First power off, then power on, within 3 seconds touch any of the Zone ' | ' button 1 time shortly, the link is done when you see the light blinks 3 times, otherwise try again later.

**Unlink:** First power off, then power on, within 3 seconds, long press the Zone ' | ' button or the Master ' | ' button, the unlink is done when you see the light blinks 9 times, otherwise try again later.

## B4 & T4

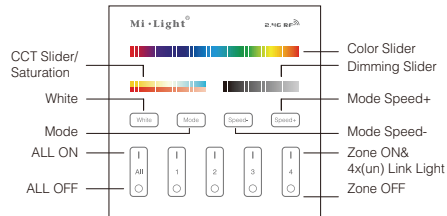

Touch Color Slider, Choose the color you want.

Under white light mode, touch the slider to change color temperature;  
Under color mode, touch the slider to change the saturation.

Touch Dimming Slider to change the brightness from 1~100%.

Touch White button to white light mode.

Switching Modes.

Slow the speed on present dynamic mode.

Accelerate the speed on present dynamic mode.



**ALL ON:** Touch turn on all linked lights.  
Long press 5 seconds to turn ON the indicating sound.

**Zone(1-4) ON:** Touch Zone ON, Turn on zone-linked lights.



**ALL OFF:** Touch turn off all linked lights.  
Long press 5 seconds to turn OFF the indicating sound.

**Zone(1-4) OFF:** Touch Zone OFF, Turn off zone-linked lights.

### Link / Unlink

**Link:** First power off, then power on, within 3 seconds touch any of the Zone '1' button 3 times shortly, the link is done when you see the light blinks 3 times with green color, otherwise try again later.

**Unlink:** First power off, then power on, within 3 seconds touch the linked Zone '1' button or the Master '1' button 5 times shortly, the unlink is done when you see the light blinks 10 times with red color, otherwise try again later.